

2.54mm I.D.C. FEMALE LATCED HEADER

5438 SERIES 2.54mm (.100") Latched Style

Features

- Available in 10, 14, 16, 20, 24, 26, 30, 34, 40, 50, 60 and 64 circuits
- Insulator Material: Glass filled polyester UL 94V-0
- Contact Material: Brass
- Available with or without fixing ears
- Shrouded polarised latched header
- Different plating options are available
- Latched connector with or without strain relief

Dimensional Information

Ordering and Dimensional Information

CIRCUITOS	CÓDIGO	DIMENSIONES					
		A	B	C	D	E	F
10	5438 – T10B	31.96 (1.258)	25.40 (1.000)	10.16 (0.400)	21.84 (0.860)	17.96 (0.708)	47.08 (1.853)
14	5438 – T14B	37.10 (1.460)	30.48 (1.200)	15.24 (0.600)	26.92 (1.060)	23.04 (0.908)	52.18 (2.054)
16	5438 – T16B	39.62 (1.560)	33.02 (1.300)	17.78 (0.700)	29.46 (1.160)	25.58 (1.008)	54.84 (2.151)
20	5438 – T20B	44.74 (1.760)	38.10 (1.500)	22.86 (0.900)	34.54 (1.360)	30.66 (1.208)	59.90 (2.351)
24	5438 – T24B	49.82 (1.960)	45.72 (1.800)	27.94 (1.100)	39.62 (1.560)	35.74 (1.407)	64.98 (2.550)
26	5438 – T26B	52.22 (2.060)	48.26 (1.900)	30.48 (1.200)	42.16 (1.660)	38.28 (1.508)	67.24 (2.651)
30	5438 – T30B	57.46 (2.260)	53.34 (2.100)	35.56 (1.400)	47.24 (1.860)	43.36 (1.707)	72.64 (2.850)
34	5438 – T34B	62.52 (2.460)	58.42 (2.300)	40.64 (1.600)	52.32 (2.060)	48.44 (1.908)	77.48 (3.051)
40	5438 – T40B	70.18 (2.760)	66.04 (2.600)	48.26 (1.900)	59.94 (2.360)	56.60 (2.228)	85.36 (3.351)
50	5438 – T50B	82.74 (3.260)	78.74 (3.100)	60.96 (2.400)	72.64 (2.860)	68.76 (2.708)	97.90 (3.851)
60	5438 – T60B	95.68 (3.760)	91.44 (3.600)	73.66 (2.900)	85.34 (3.360)	81.46 (3.208)	110.66 (4.351)
64	5438 – T64B	100.70 (3.960)	96.52 (3.800)	78.74 (3.100)	90.42 (3.560)	86.54 (3.408)	115.62 (4.551)

T = Contact Plating

- T = 2. Tin plated
- T = 3. Gold flash over 50µ" nickel
Recommended Finish
- T = 5. 15µ" gold over 50µ" nickel
- T = 6. 30µ" gold over 50µ" nickel

X = Latch Type

- X = 1. Short latches. Without Flanges
- X = 2. Long latches. Without Flanges
- X = 3. Long latches. With Flanges
- X = 4. Short latches. With Flanges

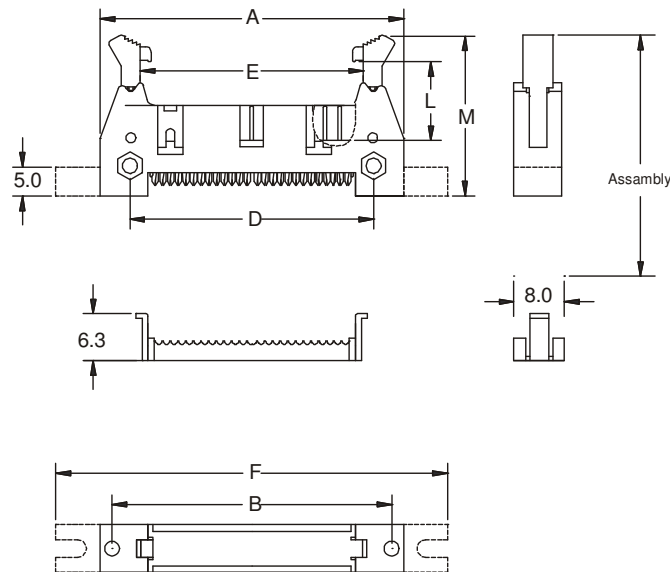
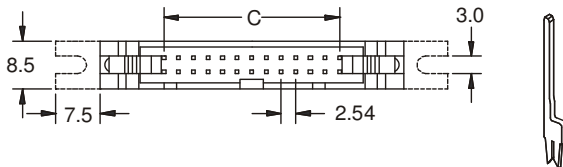

Latch Type	L	M
Long latch	14.60	29.20
Short latch	10.60	25.60

