

# TOP ENTRY PCB JACK FCC-68

## 7632 SERIES For PCB Solder. Top Entry PCB Jack

### Features

- Available in 4/4, 6/2, 6/4, 6/6, 8/2, 8/4, 8/6 and 8/8 circuits
- Mates with FCC-68 modular plugs
- Insulator Material: Glass filled polyester UL 94V-0
- Contacts: Golden phosphor bronze 0.35mm square
- Gold plating over nickel in Contact Area.
- Tin plating over nickel in Solder Area
- Optional: Cat. 5 version

### Dimensional Information

### Ordering and Dimensional Information

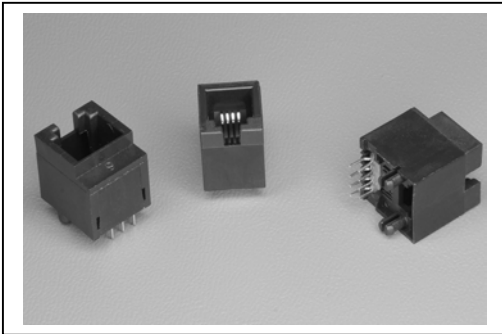

VERSIÓN	CÓDIGOS		DIMENSIONES		
	Estándar	Categoría 5	A	B	C
4/4	7632 - T441	7632 - T445	11.18 (0.440)	7.62 (0.300)	3.81 (0.150)
6/2	7632 - T621	7632 - T625	13.21 (0.520)	10.16 (0.400)	1.27 (0.050)
6/4	7632 - T641	7632 - T645	13.21 (0.520)	10.16 (0.400)	3.81 (0.150)
6/6	7632 - T661	7632 - T665	13.21 (0.520)	10.16 (0.400)	6.35 (0.250)
8/2	7632 - T821	7632 - T825	15.25 (0.600)	11.43 (0.450)	1.27 (0.050)
8/4	7632 - T841	7632 - T845	15.25 (0.600)	11.43 (0.450)	3.81 (0.150)
8/6	7632 - T861	7632 - T865	15.25 (0.600)	11.43 (0.450)	6.35 (0.250)
8/8	7632 - T881	7632 - T885	15.25 (0.600)	11.43 (0.450)	8.89 (0.350)

### T = Contact Plating

- T = 4. 6µ" gold over 50µ" nickel
- T = 5. 15µ" gold over 50µ" nickel
- T = 6. 30µ" gold over 50µ" nickel
- T = 7. 50µ" gold over 50µ" nickel

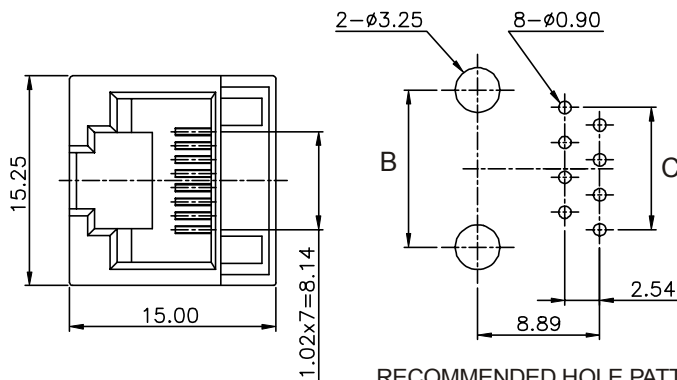

RECOMMENDED HOLE PATTERN

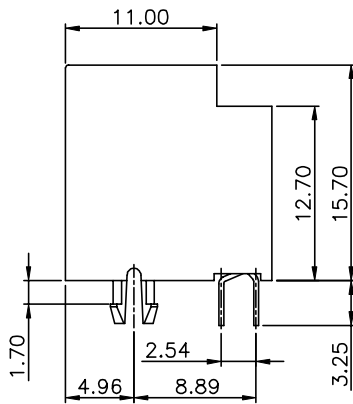

### CAT.5 VERSION

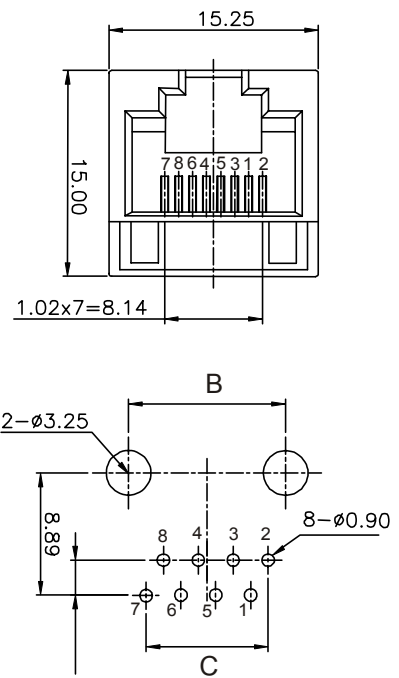

RECOMMENDED HOLE PATTERN