

# RIGHT ANGLE POLARISED HEADER

## 1343 SERIES 1.27 x 1.27mm (0.050 x 0.050") Low profile

### Features

- Available in 10, 12, 14, 16, 20, 22, 26, 30, 34, 40, 44 and 50 circuits
- Available in 10, 12, 14, 16, 20, 22, 26, 30, 34, 40, 44 and 50 circuits
- Mates with Female Socket 1.27 x 1.27mm 1341 series
- Phosphor bronze terminal with different plating
- Insulator material: Nylon 6T UL 94V-0
- Polarised

### Dimensional information:

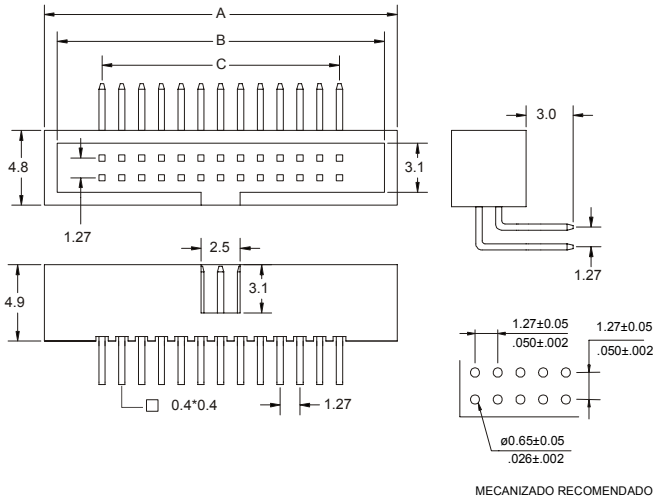

### Ordering and dimensional information:

Circuit Size	Part Number	Dimensions		
		A	B	C
10	1343 - T100	12.50 (0.492)	10.85 (0.426)	5.08 (0.200)
12	1343 - T120	13.78 (0.542)	12.12 (0.477)	6.35 (0.250)
14	1343 - T140	15.05 (0.592)	13.39 (0.527)	7.62 (0.300)
16	1343 - T160	16.32 (0.642)	14.66 (0.577)	8.89 (0.350)
20	1343 - T200	18.86 (0.742)	17.20 (0.677)	11.43 (0.450)
22	1343 - T220	20.13 (0.792)	18.47 (0.727)	12.70 (0.500)
26	1343 - T260	22.67 (0.892)	21.01 (0.827)	15.24 (0.600)
30	1343 - T300	25.21 (0.992)	23.55 (0.927)	17.78 (0.700)
34	1343 - T340	27.75 (1.092)	26.09 (1.027)	20.32 (0.800)
40	1343 - T400	31.56 (1.242)	29.90 (1.177)	24.13 (0.950)
44	1343 - T440	34.10 (1.342)	32.44 (1.277)	26.67 (1.050)
50	1343 - T500	37.91 (1.492)	36.25 (1.427)	30.48 (1.200)

### T = Contact Plating

- T = 2. Tin plated
- T = 3. Gold flash over 50µ" nickel.  
Recommended Finish
- T = 5. 15µ" gold over 50µ" nickel
- T = 6. 30µ" gold over 50µ" nickel

# STRAIGHT POLARISED SMT HEADER

## 1344 SERIES 1.27 x 1.27mm (0.050 x 0.050") Low profile

### Features

- Available in 10, 12, 14, 16, 20, 22, 26, 30, 34, 40, 44 and 50 circuits
- Available in 10, 12, 14, 16, 20, 22, 26, 30, 34, 40, 44 and 50 circuits
- Mates with Female Socket 1.27 x 1.27mm 1341 series
- Phosphor bronze terminal with different plating
- Insulator material: glass filled polyester UL 94V-0
- Polarised

### Dimensional information:

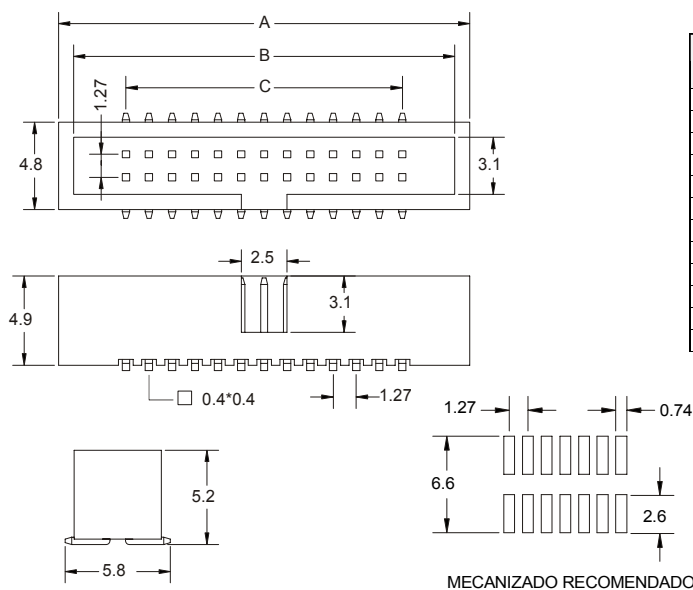

### Ordering and dimensional information:

Circuit Size	Part Number	Dimensions		
		A	B	C
10	1344 - T100	12.50 (0.492)	10.85 (0.426)	5.08 (0.200)
12	1344 - T120	13.78 (0.542)	12.12 (0.477)	6.35 (0.250)
14	1344 - T140	15.05 (0.592)	13.39 (0.527)	7.62 (0.300)
16	1344 - T160	16.32 (0.642)	14.66 (0.577)	8.89 (0.350)
20	1344 - T200	18.86 (0.742)	17.20 (0.677)	11.43 (0.450)
22	1344 - T220	20.13 (0.792)	18.47 (0.727)	12.70 (0.500)
26	1344 - T260	22.67 (0.892)	21.01 (0.827)	15.24 (0.600)
30	1344 - T300	25.21 (0.992)	23.55 (0.927)	17.78 (0.700)
34	1344 - T340	27.75 (1.092)	26.09 (1.027)	20.32 (0.800)
40	1344 - T400	31.56 (1.242)	29.90 (1.177)	24.13 (0.950)
44	1344 - T440	34.10 (1.342)	32.44 (1.277)	26.67 (1.050)
50	1344 - T500	37.91 (1.492)	36.25 (1.427)	30.48 (1.200)

### T = Contact Plating

- T = 2. Tin plated
- T = 3. Gold flash over 50µ" nickel.  
Recommended Finish
- T = 5. 15µ" gold over 50µ" nickel
- T = 6. 30µ" gold over 50µ" nickel