

5.00mm SINGLE ROW RIGHT ANGLE HEADER



5018 SERIES 5.00mm (0.197") Square Pin. For PCB Solder

Features

- Available in 2 through 20 circuits
- Insulator Material: Nylon 6/6 UL 94V-0
- 1.14mm (.045") square pin in tinned brass
- Easy breakaway to desired circuits
- Mates with 5000 series socket
- With standoff minimise flux retention
- Pin omit options are available
- For other options consult the Sales Office

Dimensional Information

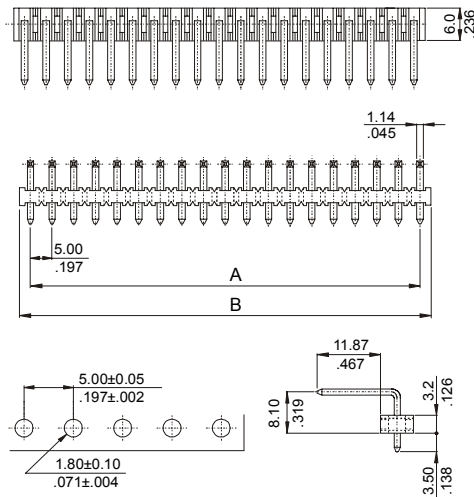

RECOMMENDED HOLE PATTERN

Ordering and Dimensional Information

Circuit Size	Part Number	Dimensions	
		A	B
02	5018-2021	5,00(0,197)	10,00(0,394)
03	5018-2031	10,00(0,394)	15,00(0,591)
04	5018-2041	15,00(0,591)	20,00(0,787)
05	5018-2051	20,00(0,787)	25,00(0,984)
06	5018-2061	25,00(0,984)	30,00(1,181)
07	5018-2071	30,00(1,181)	35,00(1,378)
08	5018-2081	35,00(1,378)	40,00(1,575)
09	5018-2091	40,00(1,575)	45,00(1,772)
10	5018-2101	45,00(1,772)	50,00(1,969)
11	5018-2111	50,00(1,969)	55,00(2,165)
12	5018-2121	55,00(2,165)	60,00(2,362)
13	5018-2131	60,00(2,362)	65,00(2,559)
14	5018-2141	65,00(2,559)	70,00(2,756)
15	5018-2151	70,00(2,756)	75,00(2,953)
16	5018-2161	75,00(2,953)	80,00(3,150)
17	5018-2171	80,00(3,150)	85,00(3,346)
18	5018-2181	85,00(3,346)	90,00(3,543)
19	5018-2191	90,00(3,543)	95,00(3,740)
20	5018-2201	95,00(3,740)	100,00(3,937)

SINGLE ROW STRAIGHT POLARISED HEADER



5004 SERIES 5.00mm (0.197") Round Pin. For PCB Solder

Features

- Available in 2 through 16 circuits
- Insulation Material: Nylon 6/6 UL 94V-0
- 1.14mm (.045") round pin in copper alloy
- Mates with 5000 series socket
- Polarised with moulded friction lock
- Pin omit options are available

Dimensional Information

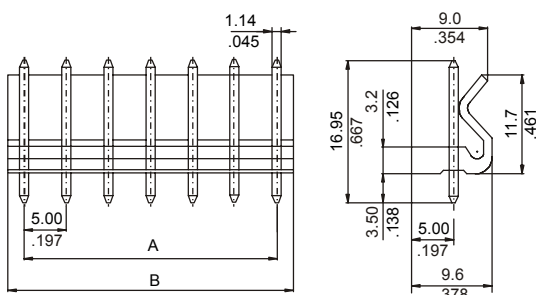

RECOMMENDED HOLE PATTERN

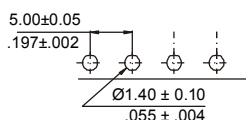

Ordering and Dimensional Information

Circuit Size	Part Number	Dimensions	
		A	B
02	5004-2021	5,00(0,197)	10,00(0,394)
03	5004-2031	10,00(0,394)	15,00(0,591)
04	5004-2041	15,00(0,591)	20,00(0,787)
05	5004-2051	20,00(0,787)	25,00(0,984)
06	5004-2061	25,00(0,984)	30,00(1,181)
07	5004-2071	30,00(1,181)	35,00(1,378)
08	5004-2081	35,00(1,378)	40,00(1,575)
09	5004-2091	40,00(1,575)	45,00(1,772)
10	5004-2101	45,00(1,772)	50,00(1,969)
11	5004-2111	50,00(1,969)	55,00(2,165)
12	5004-2121	55,00(2,165)	60,00(2,362)
13	5004-2131	60,00(2,362)	65,00(2,559)
14	5004-2141	65,00(2,559)	70,00(2,756)
15	5004-2151	70,00(2,756)	75,00(2,953)
16	5004-2161	75,00(2,953)	80,00(3,150)