

# 5.00mm SINGLE ROW BREAKAWAY HEADER



## 5016 SERIES 5.00mm (0.197") Round Pin. For PCB Solder

### Features

- Available in 2 through 20 circuits
- Insulator Material: Nylon 6/6 UL 94V-0
- 1.14mm (.045") round pin in tinned brass
- Easy breakaway to desired circuits
- Mates with 5000 series socket
- With standoff minimise flux retention
- Pin omit options are available
- For other options consult the Sales Office

### Dimensional Information

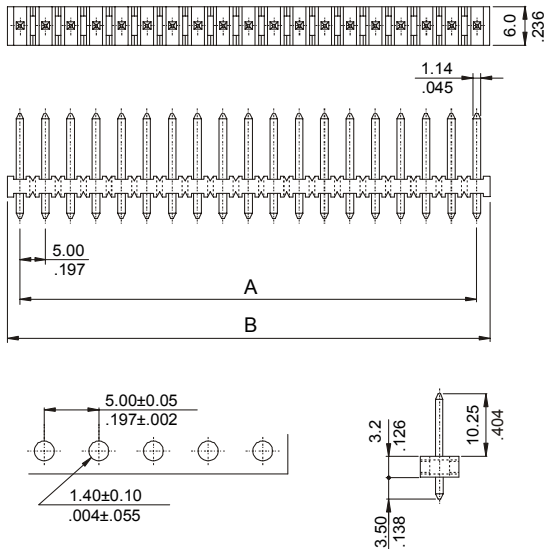

RECOMMENDED HOLE PATTERN

### Ordering and Dimensional Information

Circuit Size	Part Number	Dimensions	
		A	B
02	5016-2021	5,00(0,197)	10,00(0,394)
03	5016-2031	10,00(0,394)	15,00(0,591)
04	5016-2041	15,00(0,591)	20,00(0,787)
05	5016-2051	20,00(0,787)	25,00(0,984)
06	5016-2061	25,00(0,984)	30,00(1,181)
07	5016-2071	30,00(1,181)	35,00(1,378)
08	5016-2081	35,00(1,378)	40,00(1,575)
09	5016-2091	40,00(1,575)	45,00(1,772)
10	5016-2101	45,00(1,772)	50,00(1,969)
11	5016-2111	50,00(1,969)	55,00(2,165)
12	5016-2121	55,00(2,165)	60,00(2,362)
13	5016-2131	60,00(2,362)	65,00(2,559)
14	5016-2141	65,00(2,559)	70,00(2,756)
15	5016-2151	70,00(2,756)	75,00(2,953)
16	5016-2161	75,00(2,953)	80,00(3,150)
17	5016-2171	80,00(3,150)	85,00(3,346)
18	5016-2181	85,00(3,346)	90,00(3,543)
19	5016-2191	90,00(3,543)	95,00(3,740)
20	5016-2201	95,00(3,740)	100,00(3,937)

# 5.00mm SINGLE ROW BREAKAWAY HEADER



## 5017 SERIES 5.00mm (0.197") Square Pin. For PCB Solder

### Features

- Available in 2 through 20 circuits
- Insulator Material: Nylon 6/6 UL 94V-0
- 1.14mm(.045") square pin in tinned brass
- Easy breakaway to desired circuits
- Mates with 5000 series socket
- With standoff minimise flux retention
- Pin omit options are available
- For other options consult the Sales Office

### Dimensional Information

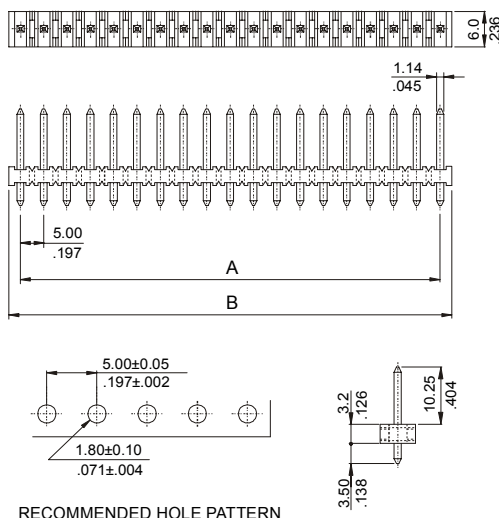

RECOMMENDED HOLE PATTERN

### Ordering and Dimensional Information

Circuit Size	Part Number	Dimensions	
		A	B
02	5017-2021	5,00(0,197)	10,00(0,394)
03	5017-2031	10,00(0,394)	15,00(0,591)
04	5017-2041	15,00(0,591)	20,00(0,787)
05	5017-2051	20,00(0,787)	25,00(0,984)
06	5017-2061	25,00(0,984)	30,00(1,181)
07	5017-2071	30,00(1,181)	35,00(1,378)
08	5017-2081	35,00(1,378)	40,00(1,575)
09	5017-2091	40,00(1,575)	45,00(1,772)
10	5017-2101	45,00(1,772)	50,00(1,969)
11	5017-2111	50,00(1,969)	55,00(2,165)
12	5017-2121	55,00(2,165)	60,00(2,362)
13	5017-2131	60,00(2,362)	65,00(2,559)
14	5017-2141	65,00(2,559)	70,00(2,756)
15	5017-2151	70,00(2,756)	75,00(2,953)
16	5017-2161	75,00(2,953)	80,00(3,150)
17	5017-2171	80,00(3,150)	85,00(3,346)
18	5017-2181	85,00(3,346)	90,00(3,543)
19	5017-2191	90,00(3,543)	95,00(3,740)
20	5017-2201	95,00(3,740)	100,00(3,937)