

CRIMP TERMINAL HOUSING

3930 SERIES 3.96mm (0.156") With Locking Ramp

Features

- Available in 2 through 15 circuits
- Insulator Material: Nylon 6/6 UL 94V-2
- Accepts 3933 and 3934 series crimp terminals
- Mates with 3963, 3966, 3968, 3986, 3987 and 3988 series headers
- Moulded pull tab
- Moulded in locking arm for terminal retention
- Polarisation through varied centre spacing between circuit 1 and 2

Dimensional Information

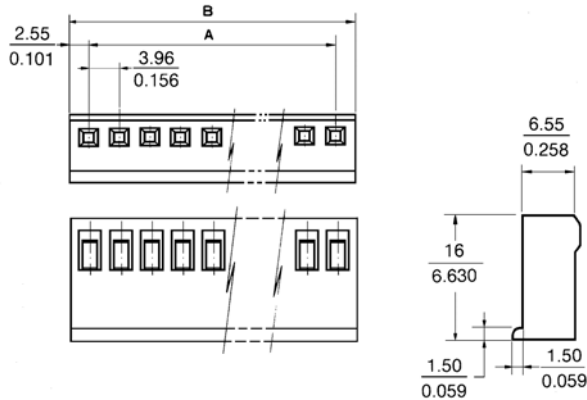

Ordering and Dimensional Information

| Circuit Size | Part Number | Dimensions | |
|--------------|-------------|--------------|--------------|
| | | A | B |
| 02 | 3930-2021 | 3,96(0,156) | 9,06(0,357) |
| 03 | 3930-2031 | 7,92(0,312) | 13,02(0,513) |
| 04 | 3930-2041 | 11,88(0,468) | 16,98(0,669) |
| 05 | 3930-2051 | 15,84(0,624) | 20,94(0,824) |
| 06 | 3930-2061 | 19,80(0,780) | 24,90(0,980) |
| 07 | 3930-2071 | 23,76(0,935) | 28,86(1,136) |
| 08 | 3930-2081 | 27,72(1,091) | 32,82(1,292) |
| 09 | 3930-2091 | 31,68(1,247) | 36,78(1,448) |
| 10 | 3930-2101 | 35,64(1,403) | 40,74(1,604) |
| 11 | 3930-2111 | 39,60(1,559) | 44,70(1,760) |
| 12 | 3930-2121 | 43,56(1,715) | 48,66(1,916) |
| 13 | 3930-2131 | 47,52(1,871) | 52,62(2,072) |
| 14 | 3930-2141 | 51,48(2,027) | 56,58(2,228) |
| 15 | 3930-2151 | 55,44(2,183) | 60,54(2,383) |

CRIMP TERMINAL

3933 - 3934 SERIES Crimp Terminal

Features

- Material: Tin plated brass
- Mates with 1.14mm (.045") square pin
- Insulation Diameter: 3.20mm maximum
- Mates with 3930 and 5081 series housing
- Anti-fish hooking contact design
- Four contact points

Dimensional Information

Ordering and Dimensional Information

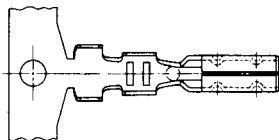

| Reel Quantity | Part Number | Material | Wire Size | Diameter |
|------------------|-------------|---------------|-------------|---------------|
| 5,000 Pcs (Reel) | 3933 - 2000 | Brass tinned. | AWG 18 - 24 | 1.3mm - 3.2mm |
| Loose Piece | 3933 - 2001 | Brass tinned. | AWG 18 - 24 | 1.3mm - 3.2mm |
| 5,000 Pcs (Reel) | 3934 - 2000 | Brass tinned. | AWG 22 - 28 | 1.2mm - 2.6mm |
| Loose Piece | 3934 - 2001 | Brass tinned. | AWG 22 - 28 | 1.2mm - 2.6mm |

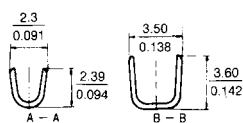

3933

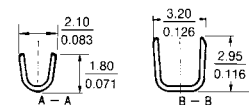
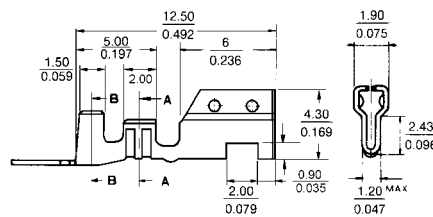

3934