

CRIMP TERMINAL HOUSING



3930 SERIES 3.96mm (0.156") With Locking Ramp

Features

- Available in 2 through 15 circuits
- Insulator Material: Nylon 6/6 UL 94V-2
- Accepts 3933 and 3934 series crimp terminals
- Mates with 3963, 3966, 3968, 3986, 3987 and 3988 series headers
- Moulded pull tab
- Moulded in locking arm for terminal retention
- Polarisation through varied centre spacing between circuit 1 and 2

Dimensional Information

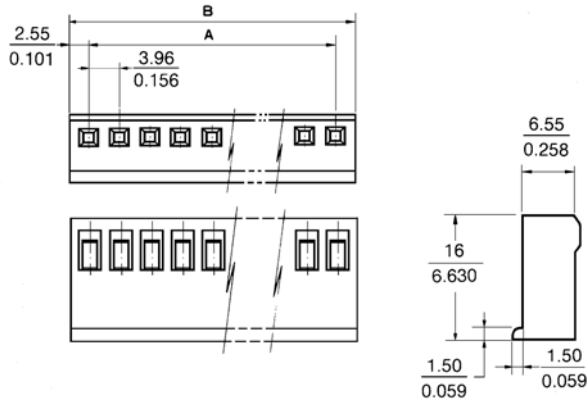

Ordering and Dimensional Information

Circuit Size	Part Number	Dimensions	
		A	B
02	3930-2021	3,96(0,156)	9,06(0,357)
03	3930-2031	7,92(0,312)	13,02(0,513)
04	3930-2041	11,88(0,468)	16,98(0,669)
05	3930-2051	15,84(0,624)	20,94(0,824)
06	3930-2061	19,80(0,780)	24,90(0,980)
07	3930-2071	23,76(0,935)	28,86(1,136)
08	3930-2081	27,72(1,091)	32,82(1,292)
09	3930-2091	31,68(1,247)	36,78(1,448)
10	3930-2101	35,64(1,403)	40,74(1,604)
11	3930-2111	39,60(1,559)	44,70(1,760)
12	3930-2121	43,56(1,715)	48,66(1,916)
13	3930-2131	47,52(1,871)	52,62(2,072)
14	3930-2141	51,48(2,027)	56,58(2,228)
15	3930-2151	55,44(2,183)	60,54(2,383)

CRIMP TERMINAL



3933 - 3934 SERIES Crimp Terminal

Features

- Material: Tin plated brass
- Mates with 1.14mm (.045") square pin
- Insulation Diameter: 3.20mm maximum
- Mates with 3930 and 5081 series housing
- Anti-fish hooking contact design
- Four contact points

Dimensional Information

Ordering and Dimensional Information

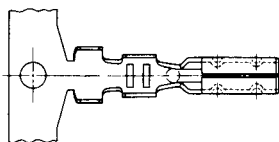

Reel Quantity	Part Number	Material	Wire Size	Diameter
5,000 Pcs (Reel)	3933-2000	Brass tinned.	AWG 18 - 24	1.3mm - 3.2mm
Loose Piece	3933-2001	Brass tinned.	AWG 18 - 24	1.3mm - 3.2mm
5,000 Pcs (Reel)	3934-2000	Brass tinned.	AWG 22 - 28	1.2mm - 2.6mm
Loose Piece	3934-2001	Brass tinned.	AWG 22 - 28	1.2mm - 2.6mm

