

# 2.00mm SINGLE ROW PCB SOCKET SMT

## 2166 SERIES 2.00mm (0.079") PCB Solder Bottom Entry

### Features

- Available in 4 through 40 circuits
- Material: Nylon 6-T UL 94V-0
- Mates with 2.00mm pitch and 0.50mm pin headers
- Low profile and high density PCB socket
- Height: 4.50mm
- Different plating options are available
- High quality dual beam phosphor bronze contacts
- Designed for board to board small spacing interconnection

### Dimensional Information

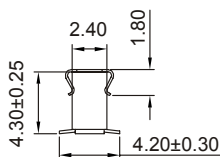
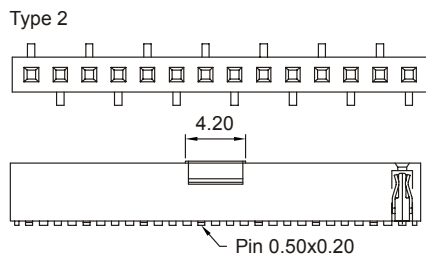
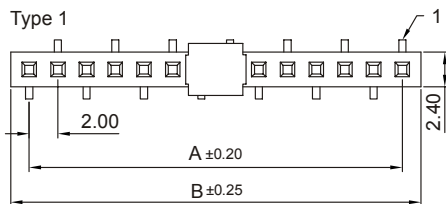
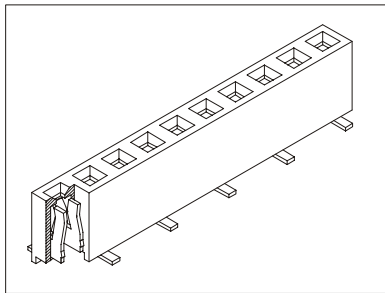

### RECOMMENDED HOLE PATTERN

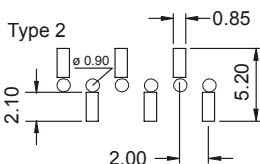
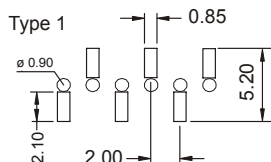

### Ordering and Dimensional Information

| Circuit Size | Part Number |            | Dimensions   |              |
|--------------|-------------|------------|--------------|--------------|
|              | Type 1      | Type 2     | A            | B            |
| 04           | 2166-T041E  | 2166-T042E | 6,00(0,236)  | 8,60(0,339)  |
| 05           | 2166-T051E  | 2166-T052E | 8,00(0,315)  | 10,60(0,417) |
| 06           | 2166-T061E  | 2166-T062E | 10,00(0,394) | 12,60(0,496) |
| 07           | 2166-T071E  | 2166-T072E | 12,00(0,472) | 14,60(0,575) |
| 08           | 2166-T081E  | 2166-T082E | 14,00(0,551) | 16,60(0,654) |
| 09           | 2166-T091E  | 2166-T092E | 16,00(0,630) | 18,60(0,732) |
| 10           | 2166-T101E  | 2166-T102E | 18,00(0,709) | 20,60(0,811) |
| 11           | 2166-T111E  | 2166-T112E | 20,00(0,787) | 22,60(0,890) |
| 12           | 2166-T121E  | 2166-T122E | 22,00(0,866) | 24,60(0,969) |
| 13           | 2166-T131E  | 2166-T132E | 24,00(0,945) | 26,60(1,047) |
| 14           | 2166-T141E  | 2166-T142E | 26,00(1,024) | 28,60(1,126) |
| 15           | 2166-T151E  | 2166-T152E | 28,00(1,102) | 30,60(1,205) |
| 16           | 2166-T161E  | 2166-T162E | 30,00(1,181) | 32,60(1,283) |
| 17           | 2166-T171E  | 2166-T172E | 32,00(1,260) | 34,60(1,362) |
| 18           | 2166-T181E  | 2166-T182E | 34,00(1,339) | 36,60(1,441) |
| 19           | 2166-T191E  | 2166-T192E | 36,00(1,417) | 38,60(1,520) |
| 20           | 2166-T201E  | 2166-T202E | 38,00(1,496) | 40,60(1,598) |
| 21           | 2166-T211E  | 2166-T212E | 40,00(1,575) | 42,60(1,677) |
| 22           | 2166-T221E  | 2166-T222E | 42,00(1,654) | 44,60(1,756) |
| 23           | 2166-T231E  | 2166-T232E | 44,00(1,732) | 46,60(1,835) |
| 24           | 2166-T241E  | 2166-T242E | 46,00(1,811) | 48,60(1,913) |
| 25           | 2166-T251E  | 2166-T252E | 48,00(1,890) | 50,60(1,992) |
| 26           | 2166-T261E  | 2166-T262E | 50,00(1,969) | 52,60(2,071) |
| 27           | 2166-T271E  | 2166-T272E | 52,00(2,047) | 54,60(2,150) |
| 28           | 2166-T281E  | 2166-T282E | 54,00(2,126) | 56,60(2,228) |
| 29           | 2166-T291E  | 2166-T292E | 56,00(2,205) | 58,60(2,307) |
| 30           | 2166-T301E  | 2166-T302E | 58,00(2,283) | 60,60(2,386) |
| 31           | 2166-T311E  | 2166-T312E | 60,00(2,362) | 62,60(2,465) |
| 32           | 2166-T321E  | 2166-T322E | 62,00(2,441) | 64,60(2,543) |
| 33           | 2166-T331E  | 2166-T332E | 64,00(2,520) | 66,60(2,622) |
| 34           | 2166-T341E  | 2166-T342E | 66,00(2,598) | 68,60(2,701) |
| 35           | 2166-T351E  | 2166-T352E | 68,00(2,677) | 70,60(2,780) |
| 36           | 2166-T361E  | 2166-T362E | 70,00(2,756) | 72,60(2,858) |
| 37           | 2166-T371E  | 2166-T372E | 72,00(2,835) | 74,60(2,937) |
| 38           | 2166-T381E  | 2166-T382E | 74,00(2,913) | 76,60(3,016) |
| 39           | 2166-T391E  | 2166-T392E | 76,00(2,992) | 78,60(3,094) |
| 40           | 2166-T401E  | 2166-T402E | 78,00(3,071) | 80,60(3,173) |

### T = Contact Plating

- T = 1. 100µ" Matte tin plating
- T = 2. Tin plated.
- T = 3. Gold flash over 50µ" nickel  
Recommended Finish
- T = 5. 15µ" gold over 50µ" nickel
- T = 6. 30µ" gold over 50µ" nickel
- T = 13. Selective gold flash over 50µ" nickel
- T = 15. 15µ" selective gold over 50µ" nickel
- T = 16. 30µ" selective gold over 50µ" nickel

### E = Parking Options

- E = 3. Tube + Film
- E = 4. Reel + Film
- E = 5. Tube + Metallic Cap