

# MALE RIGHT ANGLE HEADER

## 1147 SERIE 1.25 mm. (0.0492")

### Features

- Available in 2 to 10, 15, 20, 25 and 30 circuits
- Insulator material: Nylon 6/6 UL 94V-0
- 0.30 mm square pins
- Mates with housing 1145 serie
- Completely polarized and protected
- Low profil

### Dimensional information:

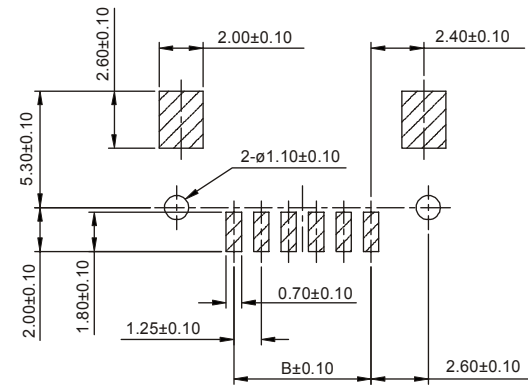
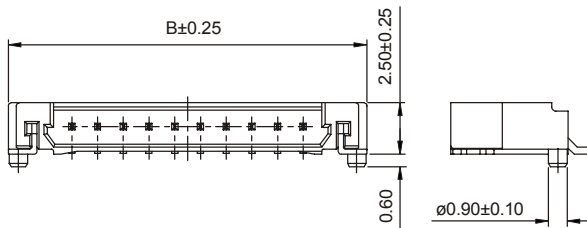
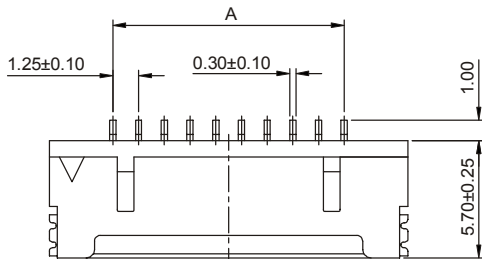

RECOMMENDED PCB LAYOUT

Circuit Size	Part Number	Dimensions	
		A	B
2	<b>1147-2021E</b>	1.25 (0.049)	7.45 (0.293)
3	<b>1147-2031E</b>	2.50 (0.098)	8.70 (0.342)
4	<b>1147-2041E</b>	3.75 (0.148)	9.95 (0.392)
5	<b>1147-2051E</b>	5.00 (0.197)	11.20 (0.441)
6	<b>1147-2061E</b>	6.25 (0.246)	12.45 (0.491)
7	<b>1147-2071E</b>	7.50 (0.295)	13.70 (0.539)
8	<b>1147-2081E</b>	8.75 (0.344)	14.95 (0.588)
9	<b>1147-2091E</b>	10.00 (0.394)	16.20 (0.638)
10	<b>1147-2101E</b>	11.25 (0.443)	17.45 (0.687)
15	<b>1147-2151E</b>	17.50 (0.689)	23.70 (0.933)
20	<b>1147-2201E</b>	23.75 (0.935)	29.95 (1.179)
25	<b>1147-2251E</b>	30.00 (1.181)	36.20 (1.425)
30	<b>1147-2301E</b>	36.25 (1.427)	42.45 (1.671)

