

SMT DUAL INSULATOR STRAIGHT HEADER

2667 SERIES 2.54 x 2.54mm (0.100 X 0.100"). For PCB solder

Features

- Available in 6 through 64 circuits
- Mates with 2.54mm(.100") dual row sockets
- Insulator Material: Thermoplastic UL 94V-0.
- 0.64mm(.025") square pin in copper alloy
- Different pin length and plating options are available
- Available with or without fixing post
- For other options consult the Sales Office

Dimensional Information:

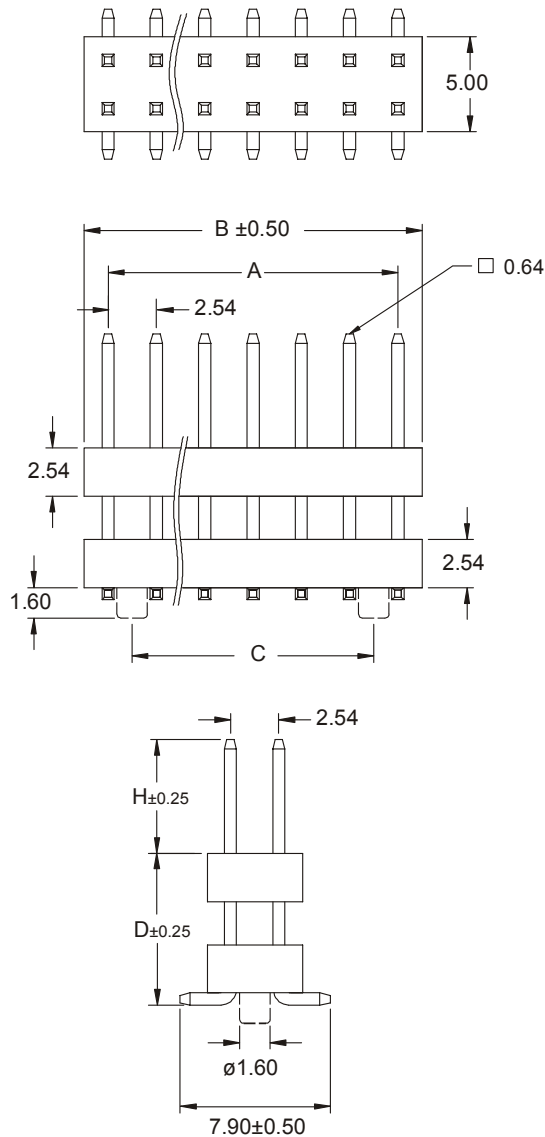

RECOMMENDED HOLE PATTERN

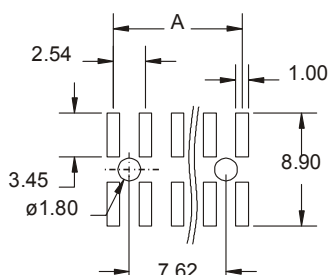

Ordering and Dimensional Information:

Circuit Size	Part Number	Dimension		
		A	B	C
06	2667-T06CPE	5,08(0,200)	7,62(0,300)	2,54(0,100)
08	2667-T08CPE	7,62(0,300)	10,16(0,400)	5,08(0,200)
10	2667-T10CPE	10,16(0,400)	12,70(0,500)	7,62(0,300)
12	2667-T12CPE	12,70(0,500)	15,24(0,600)	10,16(0,400)
14	2667-T14CPE	15,24(0,600)	17,78(0,700)	12,70(0,500)
16	2667-T16CPE	17,78(0,700)	20,32(0,800)	15,24(0,600)
18	2667-T18CPE	20,32(0,800)	22,86(0,900)	17,78(0,700)
20	2667-T20CPE	22,86(0,900)	25,40(1,000)	20,32(0,800)
22	2667-T22CPE	25,40(1,000)	27,94(1,100)	22,86(0,900)
24	2667-T24CPE	27,94(1,100)	30,48(1,200)	25,40(1,000)
26	2667-T26CPE	30,48(1,200)	33,02(1,300)	27,94(1,100)
28	2667-T28CPE	33,02(1,300)	35,56(1,400)	30,48(1,200)
30	2667-T30CPE	35,56(1,400)	38,10(1,500)	33,02(1,300)
32	2667-T32CPE	38,10(1,500)	40,64(1,600)	35,56(1,400)
34	2667-T34CPE	40,64(1,600)	43,18(1,700)	38,10(1,500)
36	2667-T36CPE	43,18(1,700)	45,72(1,800)	40,64(1,600)
38	2667-T38CPE	45,72(1,800)	48,26(1,900)	43,18(1,700)
40	2667-T40CPE	48,26(1,900)	50,80(2,000)	45,72(1,800)
42	2667-T42CPE	50,80(2,000)	53,34(2,100)	48,26(1,900)
44	2667-T44CPE	53,34(2,100)	55,88(2,200)	50,80(2,000)
46	2667-T46CPE	55,88(2,200)	58,42(2,300)	53,34(2,100)
48	2667-T48CPE	58,42(2,300)	60,96(2,400)	55,88(2,200)
50	2667-T50CPE	60,96(2,400)	63,50(2,500)	58,42(2,300)
52	2667-T52CPE	63,50(2,500)	66,04(2,600)	60,96(2,400)
54	2667-T54CPE	66,04(2,600)	68,58(2,700)	63,50(2,500)
56	2667-T56CPE	68,58(2,700)	71,12(2,800)	66,04(2,600)
58	2667-T58CPE	71,12(2,800)	73,66(2,900)	68,58(2,700)
60	2667-T60CPE	73,66(2,900)	76,20(3,000)	71,12(2,800)
62	2667-T62CPE	76,20(3,000)	78,74(3,100)	73,66(2,900)
64	2667-T64CPE	78,74(3,100)	81,28(3,200)	76,20(3,000)

T = Contact Plating

- T = 2. Tin plated
- T = 3. Gold flash over 50µ" nickel.
- T = 5. 15µ" gold over 50µ" nickel
- T = 6. 30µ" gold over 50µ" nickel
- T = 13. Selective gold flash over 50µ" nickel.
Recommended Finish
- T = 15. 15µ" selective gold over 50µ" nickel
- T = 16. 30µ" selective gold over 50µ" nickel

C = Pin length

- C = 1. Dim. H = 5.00mm ; D = 8.00mm
- C = 2. Dim. H = 6.40mm ; D = 9.80mm
- C = 3. Dim. H = 7.00mm ; D = 12.00mm
- C = 4. Dim. H = 9.00mm ; D = 12.00mm

P = Fixing post

- P = 1. Without fixing post
- P = 2. With fixing post

E = Parking Options

- E = 1. Plastic Pad + Tube
- E = 2. Plastic Pad + Reel