

# SINGLE ROW STRAIGHT LOCKING HEADER

## 3951 SERIES 3.96mm (0.156") Square Pin Header. For PCB Solder

### Features

- Available in 2 through 12 circuits
- Insulation Material: Nylon 6/6 UL 94V-0
- Mates with 3940-B and 3950 socket series
- 1.14mm(.045") square pin in tinned brass
- Polarised and with locking ramp
- For **GWT** option (Glow Wire Test Approval), please add **E** at the end of Part Number (Example: 3951-XXXXE)
- For other options consult the Sales Office

### Dimensional Information

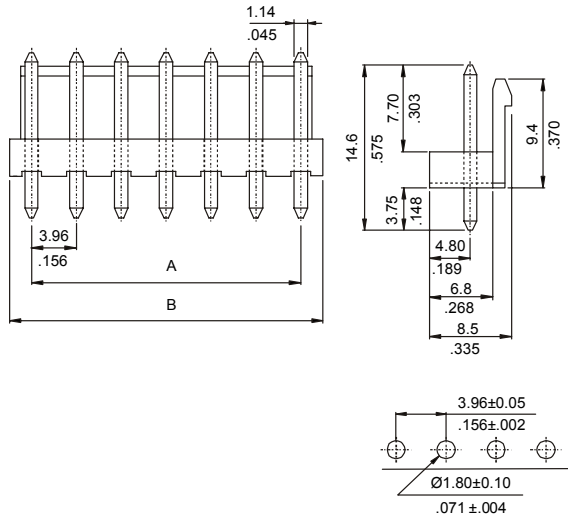

RECOMMENDED HOLE PATTERN

### Ordering and Dimensional Information

Circuit Size	Part Number	Dimensions	
		A	B
02	<b>3951-2021</b>	3,96(0,156)	7,90(0,311)
03	<b>3951-2031</b>	7,92(0,312)	11,80(0,465)
04	<b>3951-2041</b>	11,88(0,468)	15,80(0,622)
05	<b>3951-2051</b>	15,84(0,624)	19,70(0,776)
06	<b>3951-2061</b>	19,80(0,780)	23,70(0,933)
07	<b>3951-2071</b>	23,76(0,935)	27,70(1,091)
08	<b>3951-2081</b>	27,72(1,091)	31,60(1,244)
09	<b>3951-2091</b>	31,68(1,247)	35,60(1,402)
10	<b>3951-2101</b>	35,64(1,403)	39,50(1,555)
11	<b>3951-2111</b>	39,60(1,559)	43,50(1,713)
12	<b>3951-2121</b>	43,56(1,715)	47,50(1,870)

# SINGLE ROW R / ANGLE POLARISED HEADER

## 3952 SERIES 3.96mm (0.156") Square pin. For PCB Solder

### Features

- Available in 2 through 12 circuits
- Insulation Material: Nylon 6/6 UL 94V-0
- Mates with 3940-B and 3950 socket series
- 1.14mm(.045") square pin in tinned brass
- Polarised and with locking ramp
- For **GWT** option (Glow Wire Test Approval), please add **E** at the end of Part Number (Example: 3952-XXXXE)
- For other options consult the Sales Office

### Dimensional Information

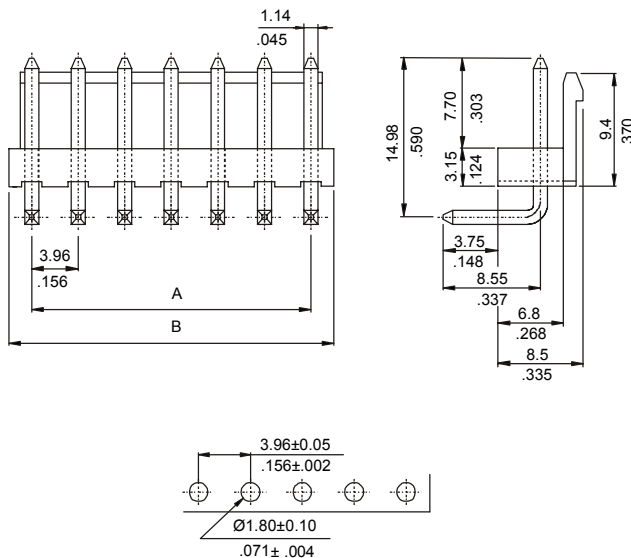

RECOMMENDED HOLE PATTERN

### Ordering and Dimensional Information

Circuit Size	Part Number	Dimensions	
		A	B
02	<b>3952-2021</b>	3,96(0,156)	7,90(0,311)
03	<b>3952-2031</b>	7,92(0,312)	11,80(0,465)
04	<b>3952-2041</b>	11,88(0,468)	15,80(0,622)
05	<b>3952-2051</b>	15,84(0,624)	19,70(0,776)
06	<b>3952-2061</b>	19,80(0,780)	23,70(0,933)
07	<b>3952-2071</b>	23,76(0,935)	27,70(1,091)
08	<b>3952-2081</b>	27,72(1,091)	31,60(1,244)
09	<b>3952-2091</b>	31,68(1,247)	35,60(1,402)
10	<b>3952-2101</b>	35,64(1,403)	39,50(1,555)
11	<b>3952-2111</b>	39,60(1,559)	43,50(1,713)
12	<b>3952-2121</b>	43,56(1,715)	47,50(1,870)