

# CRIMP TERMINAL HOUSING

## 3930 SERIES 3.96mm (0.156") With Locking Ramp

### Features

- Available in 2 through 15 circuits
- Insulator Material: Nylon 6/6 UL 94V-2
- Accepts 3933 and 3934 series crimp terminals
- Mates with 3963, 3966, 3968, 3986, 3987 and 3988 series headers
- Moulded pull tab
- Moulded in locking arm for terminal retention
- Polarisation through varied centre spacing between circuit 1 and 2

### Dimensional Information

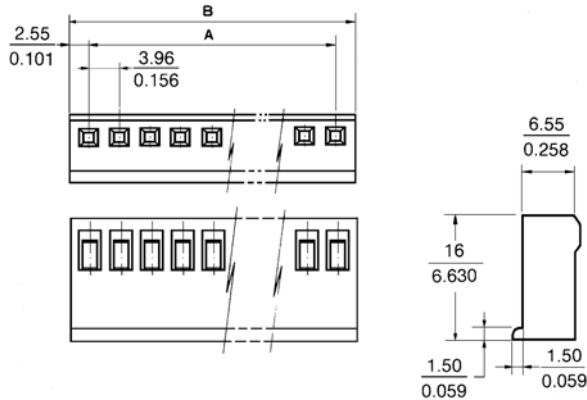

### Ordering and Dimensional Information

| Circuit Size | Part Number | Dimensions   |              |
|--------------|-------------|--------------|--------------|
|              |             | A            | B            |
| 02           | 3930-2021   | 3,96(0,156)  | 9,06(0,357)  |
| 03           | 3930-2031   | 7,92(0,312)  | 13,02(0,513) |
| 04           | 3930-2041   | 11,88(0,468) | 16,98(0,669) |
| 05           | 3930-2051   | 15,84(0,624) | 20,94(0,824) |
| 06           | 3930-2061   | 19,80(0,780) | 24,90(0,980) |
| 07           | 3930-2071   | 23,76(0,935) | 28,86(1,136) |
| 08           | 3930-2081   | 27,72(1,091) | 32,82(1,292) |
| 09           | 3930-2091   | 31,68(1,247) | 36,78(1,448) |
| 10           | 3930-2101   | 35,64(1,403) | 40,74(1,604) |
| 11           | 3930-2111   | 39,60(1,559) | 44,70(1,760) |
| 12           | 3930-2121   | 43,56(1,715) | 48,66(1,916) |
| 13           | 3930-2131   | 47,52(1,871) | 52,62(2,072) |
| 14           | 3930-2141   | 51,48(2,027) | 56,58(2,228) |
| 15           | 3930-2151   | 55,44(2,183) | 60,54(2,383) |

# CRIMP TERMINAL

## 3933 - 3934 SERIES Crimp Terminal

### Features

- Material: Tin plated brass
- Mates with 1.14mm (.045") square pin
- Insulation Diameter: 3.20mm maximum
- Mates with 3930 and 5081 series housing
- Anti-fish hooking contact design
- Four contact points

### Dimensional Information

### Ordering and Dimensional Information

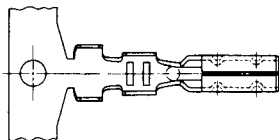

| Reel Quantity    | Part Number | Material      | Wire Gauge  | Diameter      |
|------------------|-------------|---------------|-------------|---------------|
| 5,000 Pcs (Reel) | 3933 - 2000 | Brass tinned. | AWG 18 - 24 | 1.3mm - 3.2mm |
| Loose Piece      | 3933 - 2001 | Brass tinned. | AWG 18 - 24 | 1.3mm - 3.2mm |
| 5,000 Pcs (Reel) | 3934 - 2000 | Brass tinned. | AWG 22 - 28 | 1.2mm - 2.6mm |
| Loose Piece      | 3934 - 2001 | Brass tinned. | AWG 22 - 28 | 1.2mm - 2.6mm |

