

2.00mm DUAL ROW PCB SOCKET SMT

2194 SERIES 2.00mm (0.079") Low Profile PCB Solder

Features

- Available in 06 through 80 circuits
- Material: Polyester Nylon 6-T UL 94V-0
- Mates with 2.00mm pitch and 0.50mm pin headers
- Ultra low profile (2.80mm) and high density PCB socket
- Different plating options are available
- High quality dual beam phosphor bronze contacts
- Designed for board to board small spacing interconnection
- Optional: PCB fixing post
- Bottom and Top entry
- For other options consult the Sales Office

Dimensional Information

Ordering and Dimensional Information

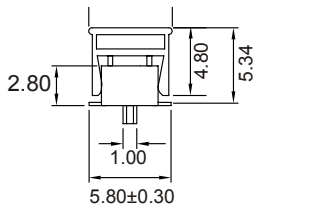
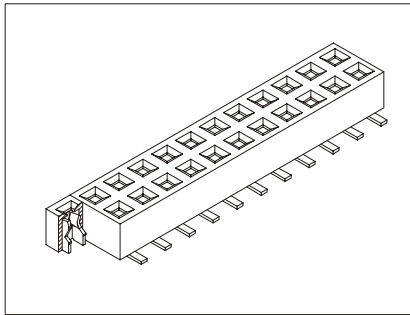

RECOMMENDED PCB LAYOUT

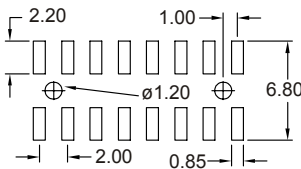

RECOMMENDED PCB LAYOUT (Bottom Entry)

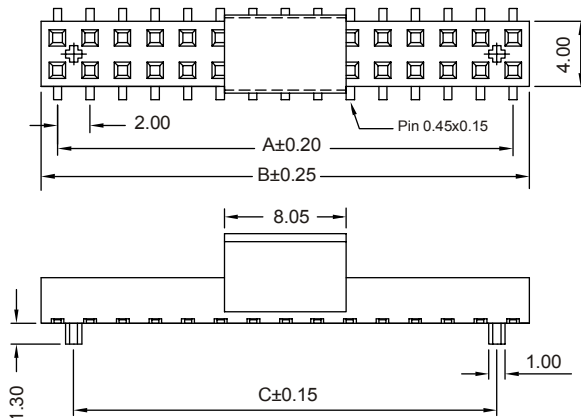
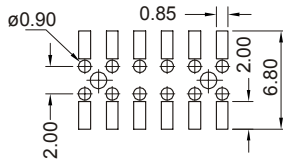

Circuit Size	Part Number		Dimensions		
	Without fixing post	With fixing post	A	B	C
06	2194-T061E	2194-T062E	4,00(0,157)	6,00(0,236)	2,00(0,079)
08	2194-T081E	2194-T082E	6,00(0,236)	8,00(0,315)	4,00(0,157)
10	2194-T101E	2194-T102E	8,00(0,315)	10,00(0,394)	6,00(0,236)
12	2194-T121E	2194-T122E	10,00(0,394)	12,00(0,472)	8,00(0,315)
14	2194-T141E	2194-T142E	12,00(0,472)	14,00(0,551)	10,00(0,394)
16	2194-T161E	2194-T162E	14,00(0,551)	16,00(0,630)	12,00(0,472)
18	2194-T181E	2194-T182E	16,00(0,630)	18,00(0,709)	14,00(0,551)
20	2194-T201E	2194-T202E	18,00(0,709)	20,00(0,787)	16,00(0,630)
22	2194-T221E	2194-T222E	20,00(0,787)	22,00(0,866)	18,00(0,709)
24	2194-T241E	2194-T242E	22,00(0,866)	24,00(0,945)	20,00(0,787)
26	2194-T261E	2194-T262E	24,00(0,945)	26,00(1,024)	22,00(0,866)
28	2194-T281E	2194-T282E	26,00(1,024)	28,00(1,102)	24,00(0,945)
30	2194-T301E	2194-T302E	28,00(1,102)	30,00(1,181)	26,00(1,024)
32	2194-T321E	2194-T322E	30,00(1,181)	32,00(1,260)	28,00(1,102)
34	2194-T341E	2194-T342E	32,00(1,260)	34,00(1,339)	30,00(1,181)
36	2194-T361E	2194-T362E	34,00(1,339)	36,00(1,417)	32,00(1,260)
38	2194-T381E	2194-T382E	36,00(1,417)	38,00(1,496)	34,00(1,339)
40	2194-T401E	2194-T402E	38,00(1,496)	40,00(1,575)	36,00(1,417)
42	2194-T421E	2194-T422E	40,00(1,575)	42,00(1,654)	38,00(1,496)
44	2194-T441E	2194-T442E	42,00(1,654)	44,00(1,732)	40,00(1,575)
46	2194-T461E	2194-T462E	44,00(1,732)	46,00(1,811)	42,00(1,654)
48	2194-T481E	2194-T482E	46,00(1,811)	48,00(1,890)	44,00(1,732)
50	2194-T501E	2194-T502E	48,00(1,890)	50,00(1,969)	46,00(1,811)
52	2194-T521E	2194-T522E	50,00(1,969)	52,00(2,047)	48,00(1,890)
54	2194-T541E	2194-T542E	52,00(2,047)	54,00(2,126)	50,00(1,969)
56	2194-T561E	2194-T562E	54,00(2,126)	56,00(2,205)	52,00(2,047)
58	2194-T581E	2194-T582E	56,00(2,205)	58,00(2,283)	54,00(2,126)
60	2194-T601E	2194-T602E	58,00(2,283)	60,00(2,362)	56,00(2,205)
62	2194-T621E	2194-T622E	60,00(2,362)	62,00(2,441)	58,00(2,283)
64	2194-T641E	2194-T642E	62,00(2,441)	64,00(2,520)	60,00(2,362)
66	2194-T661E	2194-T662E	64,00(2,520)	66,00(2,598)	62,00(2,441)
68	2194-T681E	2194-T682E	66,00(2,598)	68,00(2,677)	64,00(2,520)
70	2194-T701E	2194-T702E	68,00(2,677)	70,00(2,756)	66,00(2,598)
72	2194-T721E	2194-T722E	70,00(2,756)	72,00(2,835)	68,00(2,677)
74	2194-T741E	2194-T742E	72,00(2,835)	74,00(2,913)	70,00(2,756)
76	2194-T761E	2194-T762E	74,00(2,913)	76,00(2,992)	72,00(2,835)
78	2194-T781E	2194-T782E	76,00(2,992)	78,00(3,071)	74,00(2,913)
80	2194-T801E	2194-T802E	78,00(3,071)	80,00(3,150)	76,00(2,992)

T = Contact Plating

- T = 2. Tin plated
- T = 3. Gold flash over 50µ" nickel.
Recommended Finish
- T = 5. 15µ" gold over 50µ" nickel
- T = 6. 30µ" gold over 50µ" nickel

E = Packing Options

- E = 1. Tube + Pad
- E = 2. Reel + Pad
- E = 3. Tube + Film
- E = 4. Reel + Film