

# 2.00mm SINGLE ROW PCB SOCKET SMT

## 2166 SERIES 2.00mm (0.079") PCB Solder Bottom Entry

### Features

- Available in 4 through 40 circuits
- Material: Nylon 6-T UL 94V-0
- Mates with 2.00mm pitch and 0.50mm pin headers
- Low profile and high density PCB socket
- Height: 4.50mm
- Different plating options are available
- High quality dual beam phosphor bronze contacts
- Designed for board to board small spacing interconnection

### Dimensional Information

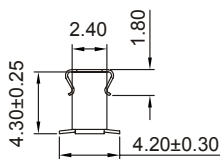
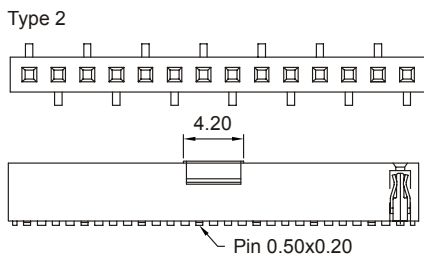
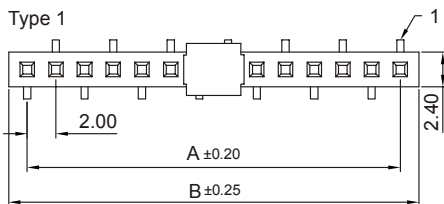
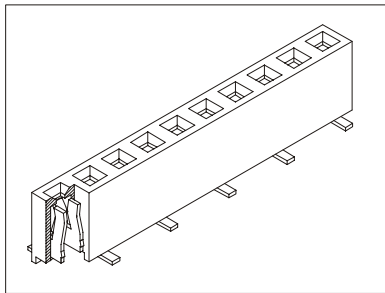

### RECOMMENDED HOLE PATTERN

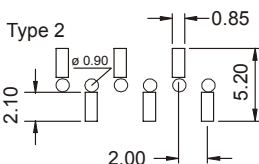
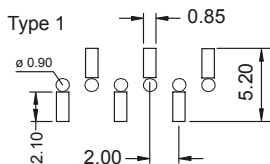

### Ordering and Dimensional Information

Circuit Size	Part Number		Dimensions	
	Type 1	Type 2	A	B
04	2166-T041E	2166-T042E	6,00(0,236)	8,60(0,339)
05	2166-T051E	2166-T052E	8,00(0,315)	10,60(0,417)
06	2166-T061E	2166-T062E	10,00(0,394)	12,60(0,496)
07	2166-T071E	2166-T072E	12,00(0,472)	14,60(0,575)
08	2166-T081E	2166-T082E	14,00(0,551)	16,60(0,654)
09	2166-T091E	2166-T092E	16,00(0,630)	18,60(0,732)
10	2166-T101E	2166-T102E	18,00(0,709)	20,60(0,811)
11	2166-T111E	2166-T112E	20,00(0,787)	22,60(0,890)
12	2166-T121E	2166-T122E	22,00(0,866)	24,60(0,969)
13	2166-T131E	2166-T132E	24,00(0,945)	26,60(1,047)
14	2166-T141E	2166-T142E	26,00(1,024)	28,60(1,126)
15	2166-T151E	2166-T152E	28,00(1,102)	30,60(1,205)
16	2166-T161E	2166-T162E	30,00(1,181)	32,60(1,283)
17	2166-T171E	2166-T172E	32,00(1,260)	34,60(1,362)
18	2166-T181E	2166-T182E	34,00(1,339)	36,60(1,441)
19	2166-T191E	2166-T192E	36,00(1,417)	38,60(1,520)
20	2166-T201E	2166-T202E	38,00(1,496)	40,60(1,598)
21	2166-T211E	2166-T212E	40,00(1,575)	42,60(1,677)
22	2166-T221E	2166-T222E	42,00(1,654)	44,60(1,756)
23	2166-T231E	2166-T232E	44,00(1,732)	46,60(1,835)
24	2166-T241E	2166-T242E	46,00(1,811)	48,60(1,913)
25	2166-T251E	2166-T252E	48,00(1,890)	50,60(1,992)
26	2166-T261E	2166-T262E	50,00(1,969)	52,60(2,071)
27	2166-T271E	2166-T272E	52,00(2,047)	54,60(2,150)
28	2166-T281E	2166-T282E	54,00(2,126)	56,60(2,228)
29	2166-T291E	2166-T292E	56,00(2,205)	58,60(2,307)
30	2166-T301E	2166-T302E	58,00(2,283)	60,60(2,386)
31	2166-T311E	2166-T312E	60,00(2,362)	62,60(2,465)
32	2166-T321E	2166-T322E	62,00(2,441)	64,60(2,543)
33	2166-T331E	2166-T332E	64,00(2,520)	66,60(2,622)
34	2166-T341E	2166-T342E	66,00(2,598)	68,60(2,701)
35	2166-T351E	2166-T352E	68,00(2,677)	70,60(2,780)
36	2166-T361E	2166-T362E	70,00(2,756)	72,60(2,858)
37	2166-T371E	2166-T372E	72,00(2,835)	74,60(2,937)
38	2166-T381E	2166-T382E	74,00(2,913)	76,60(3,016)
39	2166-T391E	2166-T392E	76,00(2,992)	78,60(3,094)
40	2166-T401E	2166-T402E	78,00(3,071)	80,60(3,173)

### T = Contact Plating

- T = 1. 100µ" Matte tin plating
- T = 2. Tin plated.
- T = 3. Gold flash over 50µ" nickel  
Recommended Finish
- T = 5. 15µ" gold over 50µ" nickel
- T = 6. 30µ" gold over 50µ" nickel
- T = 13. Selective gold flash over 50µ" nickel
- T = 15. 15µ" selective gold over 50µ" nickel
- T = 16. 30µ" selective gold over 50µ" nickel

### E = Parking Options

- E = 3. Tube + Film
- E = 4. Reel + Film
- E = 5. Tube + Metallic Cap